

F

THIS DRAWING IS AN UNCONTROLLED COPY UNLESS STAMPED OTHERWISE

CONTRACTORS SHALL VERIFY JOB DIMENSIONS BEFORE ANY JOB COMMENCES. ALL SHOP DRAWINGS SHALL BE SUBMITTED TO THE SUPERINTENDENT AND MANUFACTURER SHALL NOT COMMENCE FROM THE RETURN OF DIMENSIONS SHOP DRAWINGS ISSUED BY THE CONSULTANT. DIMENSIONS SHALL TAKE PRECEDENCE OVER SCALES. THIS DRAWING SHALL BE READ IN CONJUNCTION WITH ALL RELEVANT CONTRACT SPECIFICATIONS AND DRAWINGS COPYRIGHT OF THIS DRAWING IS VESTED IN WARDLE.

General Notes

REFER ARCHITECTURAL DRAWINGS:

- FACADE SETOUT AR1502-AR1507
- PRECAST SETOUT AR1512-AR1517
- SCREEN SETOUT AR1502-AR1557
- SCREEN DETAILS AR6550-AR6554

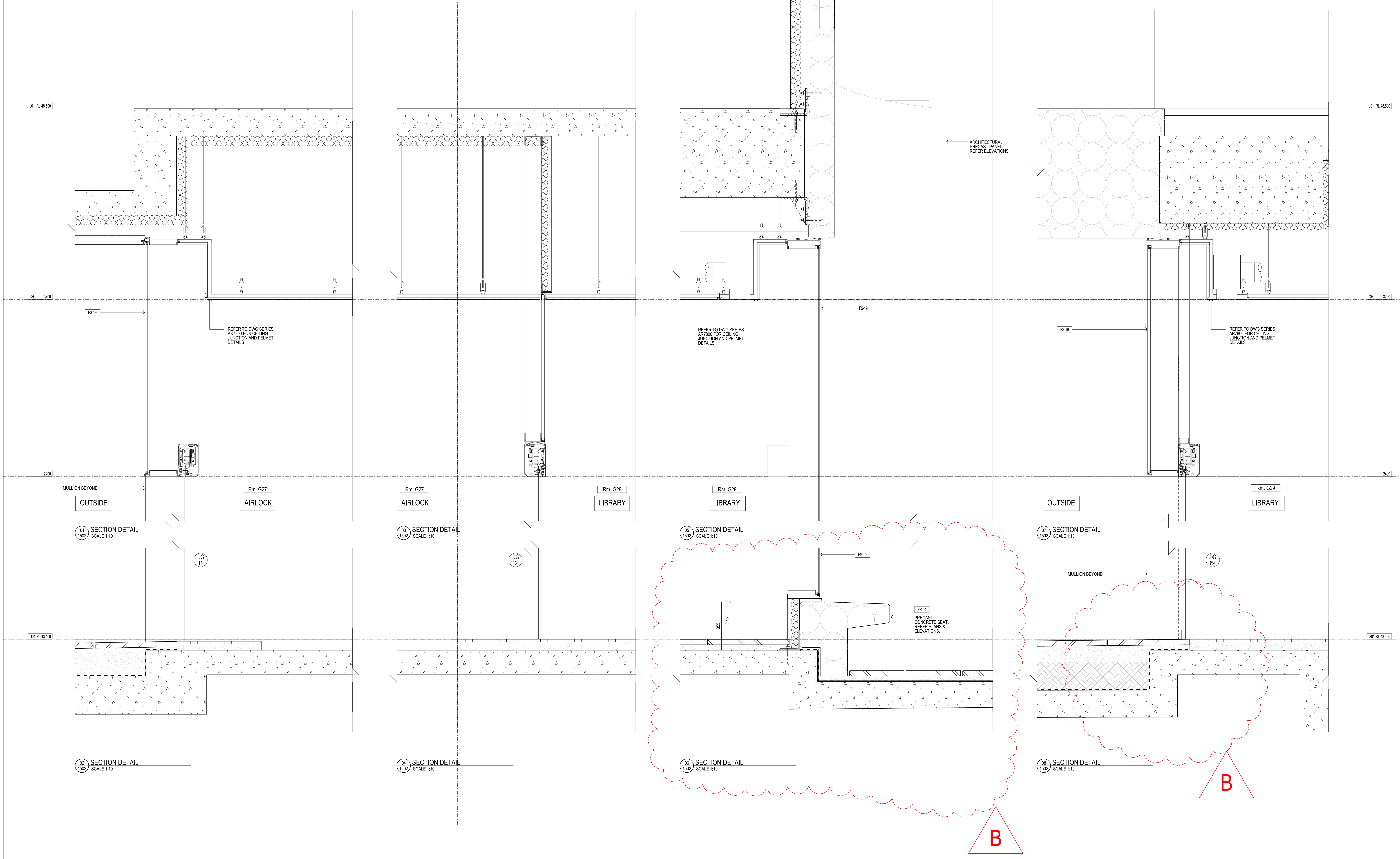

Rev	Issue	Revision Description	And	Date
B	SG	AMENDED AS NOTED		22.01.14
A	SG	ISSUE FOR CONSTRUCTION		18.10.13
10	SG	TENDER ISSUE		16.04.13
09	SG	VALUE MANAGEMENT ISSUE		28.03.13
08	SG	PRECAST REVIEW		21.03.13
07	SG	100% CD - TENDER ISSUE		07.09.12
06	SG	90% CD ISSUE		10.08.12
05	SG	50% CD ISSUE		08.06.12
04	JC	FINAL DD ISSUE		24.02.12
03	JC	DESIGN DEVELOPMENT ISSUE		20.01.12
02	JC	DESIGN DEVELOPMENT ISSUE		22.12.11
01	JC	PRELIMINARY DD		28.10.11



**NADAAA**  
 NADAAA  
 1520 Washington Street No.2 Boston Massachusetts 02118 USA  
 Telephone: +1 817 442 8232  
 Facsimile: +1 858 442 1417  
 Email: nadaaa@nadaaa.com

**John Wardle Architects**  
 25 Rokeby Street, Collingwood, Victoria 3066 Australia  
 Tel: +61 3 8662 0400 www.johnwardlearchitects.com  
 © 2014 John Wardle Architects ABN 83 006 814 268

Client: University of Melbourne Parkville Campus  
 Project: Faculty of Architecture Building and Planning

Title: SECTION DETAILS SHEET 6

Project No.	0913	Scale	1:10 @ A0 1:20 @ A2
Drawing No.	AR6105	Revision	B

FILENAME - \$FILES

FOR CONSTRUCTION